



True Perf Gourmet M404-8 25X64



True Perf Gourmet M404-8 25X64

Model number: 76TPG25644AM18

3 beds • 2 baths • 1600 sq.ft. • 25' width • 64' depth

Our home building facilities invest in continuous product and process improvements. Plans, dimensions, features, materials, specifications and availability are subject to change without notice or obligation. Renderings and floor plans are representative likenesses of our homes and may differ from the actual homes. We invite you to tour a Home Center near you and inspect the highest value in quality housing available or call (336) 597-5538 to speak with a Home Consultant. Copyright 2017, CMH. All rights reserved.

<https://www.claytonhomesroxboro.com>

**CLAYTON HOMES-
ROXBORO**

**3970 DURHAM RD
ROXBORO, NC 27574**

Monday - Thursday: 9am to 6pm
Friday: 9am to 6pm
Saturday: 9am to 5pm
Sunday: Closed

(336) 597-5538



True Perf Gourmet M404-8 25X64

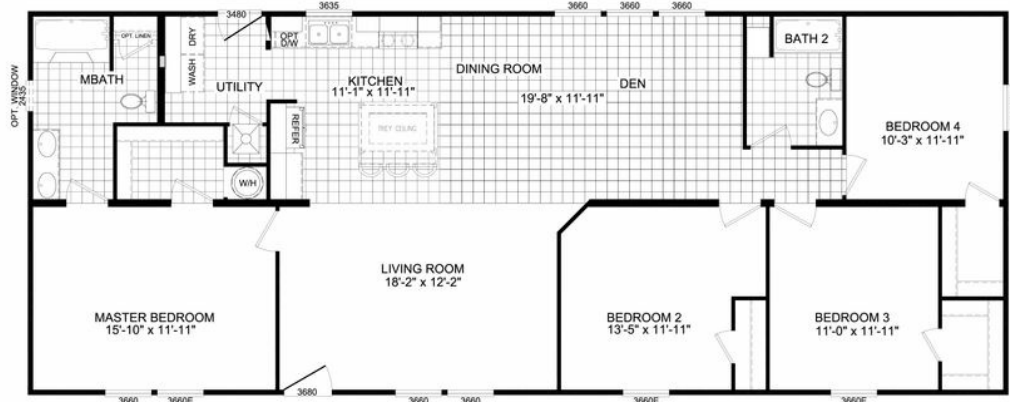

**MODEL: 76M404 - TRUE PERFORMANCE GOURMET
4-BEDROOM / 2-BATH
25x64 - Approx. 1600 Sq. Ft.**

4/11/14

* All room dimensions include closets and square footage figures are approximate.

True Perf Gourmet M404-8 25X64

Model number: 76TPG25644AM18

3 beds • 2 baths • 1600 sq.ft. • 25' width • 64' depth

Our home building facilities invest in continuous product and process improvements. Plans, dimensions, features, materials, specifications and availability are subject to change without notice or obligation. Renderings and floor plans are representative likenesses of our homes and may differ from the actual homes. We invite you to tour a Home Center near you and inspect the highest value in quality housing available or call (336) 597-5538 to speak with a Home Consultant. Copyright 2017, CMH. All rights reserved.

<https://www.claytonhomesroxboro.com>

CLAYTON HOMES-
ROXBORO

3970 DURHAM RD
ROXBORO, NC 27574

Monday - Thursday: 9am to 6pm

Friday: 9am to 6pm

Saturday: 9am to 5pm

Sunday: Closed

(336) 597-5538